



# **FRONT BUMPER**

**(TOYOTA LAND CRUISER 76)**

## **INSTALLATION MANUAL**

# PRODUCT OVERVIEW

Let me begin by thanking you for purchasing one of our products. We strive for top quality components and excellent customer service. If you have any issues during installation, don't hesitate to contact us via email at [tech@tre4x4.com](mailto:tech@tre4x4.com) and we will do everything we can to make sure any issues with our product are resolved!

# SAFETY INSTRUCTIONS

For vehicles equipped with airbags;

When installed in accordance with these instructions, the front impact bar will not affect the operation of the SRS airbags.

Please also note the following:

This product must be installed in exact accordance with these instructions using only the hardware provided.

If any impact bar component is damaged, contact your nearest authorized TRE shop.

Do not attempt to repair or modify the impact absorbing system.

Do not use this product on any vehicle make or model other than that specified by TRE.

Do not remove the label from this impact bar.

This product or its mountings must not be modified in any way.

Installation of this product may require the use of specialized tools and/or techniques

It is recommended that this product be installed by trained personnel only

These instructions are correct as of the date of publication.

Responsible for the effects of any subsequent changes made by the vehicle manufacturer

During installation, it is the installer's responsibility to check all components for proper operation/clearance

Always work safely and tighten fasteners to the specified torque unless otherwise instructed

PRODUCER: Made in china



Dear customer, thank you for choosing this product! Please check the number, name and brand of the product before installing and using the product, and beware of counterfeiting! Please read the installation instructions and steps carefully. If you encounter any problems during the installation process, please contact our after-sales personnel for technical support in time, and we will serve you at the first time. Thanks for using!

**Model:** Toyota LC76

**Product name:** Front bumper

**Product material:** aluminum magnesium alloy

Construction number: 1-2 people

Construction hours: 2 hours

Difficulty level of installation: very easy, easy, medium group, difficult, difficult

**Introduction:**

1. The bumper is made of aluminum-magnesium alloy, light in weight
2. Color black pockmark, uniform color
3. Auxiliary lights can be installed
4. Can be towed vehicles, with trailer hook
5. Increase the approach angle
6. Easy and fast installation
- 7, The original car hole installation
8. Strengthen the body protection strength
10. Can install the original car winch or refit the large-pound winch

**Tool:**

**Socket:** 14, 15, 18

**Wrench:** 14, 15, 16

**Allen wrench:** T3, T4

**Others:** Medium Quick Wrench, Large Quick Wrench

**Installation steps (text + picture):**

**Step ①:**

Remove the original car front bumper, install the front beam head winch bracket (there are two left and right brackets in total),

First fix the two screws on the side (the original car hole screws, total 4 screws)

Tools: 14socket, medium quick wrench



**Step ②:**

Fix the winch tray cover on the beam head winch tray bracket with M12\*130 screws.

From top to bottom, pass through the bottom M12 gasket + nut to lock, as shown in Figure 3, M12\*25 screw under the bracket + Gasket locking (2 pieces for each type)

Tools: 18 socket, large quick wrench





**Step ③:**

Install the bullpen on the front bumper (six inner hexagon M10\*25, M10 spacers, M10 flange nuts)  
Tools: T4 Allen wrench, 16 wrench



**Step ④:**

Install and fix the corner position of the bar leather, external small wheel eyebrows (small wheel eyebrows have left and right) (M10, M10 spacers)  
Tools: 14 socket, medium quick wrench



**Step ⑤:**

Install and fix the bar skin, there are 2 screws on the front of the bar skin, and 2 screws on the top (M10\*25 inner Hexagonal, M10 spacer)

To adjust the upper, lower, left, and right distances and gaps of the bar skin

Tools: T4 Allen wrench



**Step ⑥:**

Install the bar leather corner stabilizing bracket (the bracket has left and right sides), and fix it with 2 original car screws on the beam head,

As shown in Figure 3. Install the left bracket and fix the bar leather corner part (M10\*25 outer hexagon x 2, M10 gaskets x2, M10 flange nuts x2),

As Figure 4 Install the lower guard plate of the front bumper (M10\*25 outer hexagons x2, M10 gaskets x2)

Tools: 14 wrench, 15 wrench, 15 socket

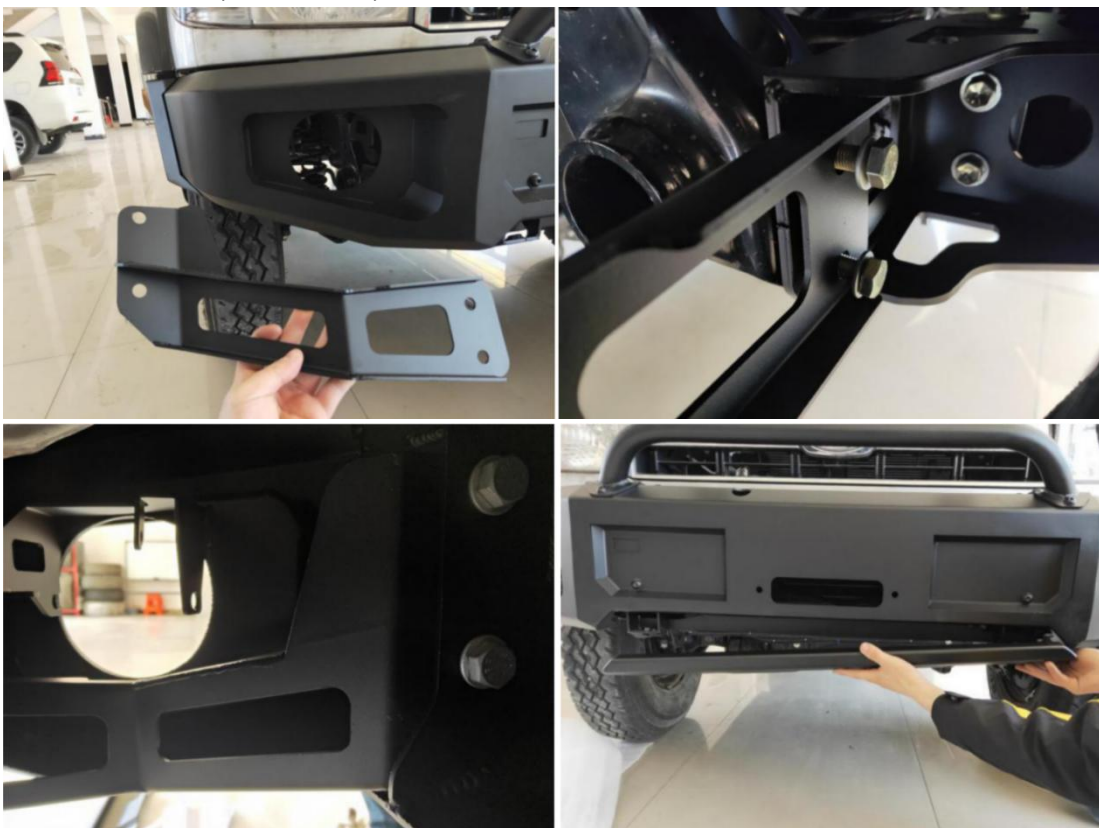

**Step ⑦:**

Put the fog lamp into the slot of the fog lamp bracket from the outside, fix the fog lamp with (M6\*15 inner hexagon screws) at the position shown in Figure 2, install and fix the fog lamp wiring harness, and adjust the light

Tools: T3 Allen wrench

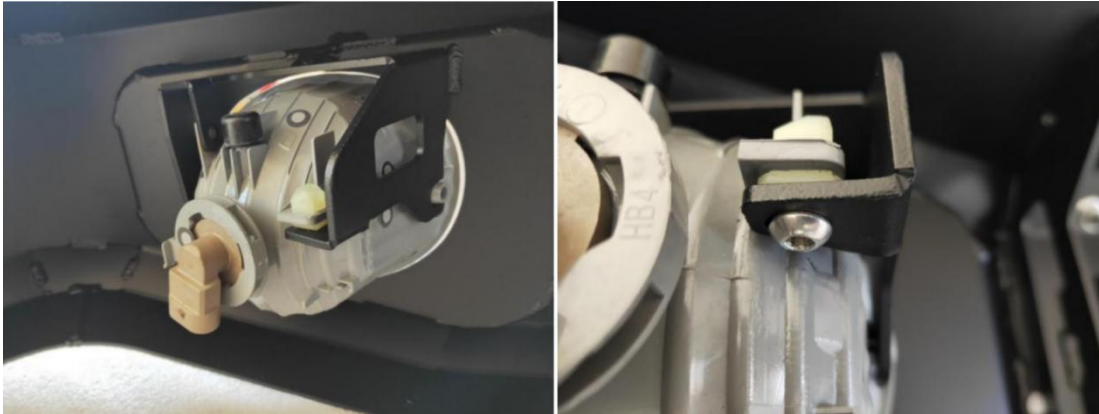

Toyota LC76 front bumper installation completed



This installation manual is for reference only, please install it according to the actual situation, If you have any questions, please contact the after-sales personnel.



[WWW.TRE4X4.COM](http://WWW.TRE4X4.COM)